

BARRIERS MAY BE REQUIRED

a) TO SAFEGUARD AGAINST PEDESTRIAN TRAFFIC APPROACHING FROM THE SIDE INTO THE SWEEP AREA (OPENING AND CLOSING) OF THE SWING DOOR.

b) TO DIRECT PEDESTRIAN TRAFFIC TOWARDS THE DOORWAY OPENING

PLEASE NOTE BARRIERS SHOULD BE POSITIONED IN SUCH A WAY THAT THEY DO NOT CAUSE AN OBSTRUCTION, OR INHIBIT MEANS OF ESCAPE OR REDUCE THE CLEAR OPENING.

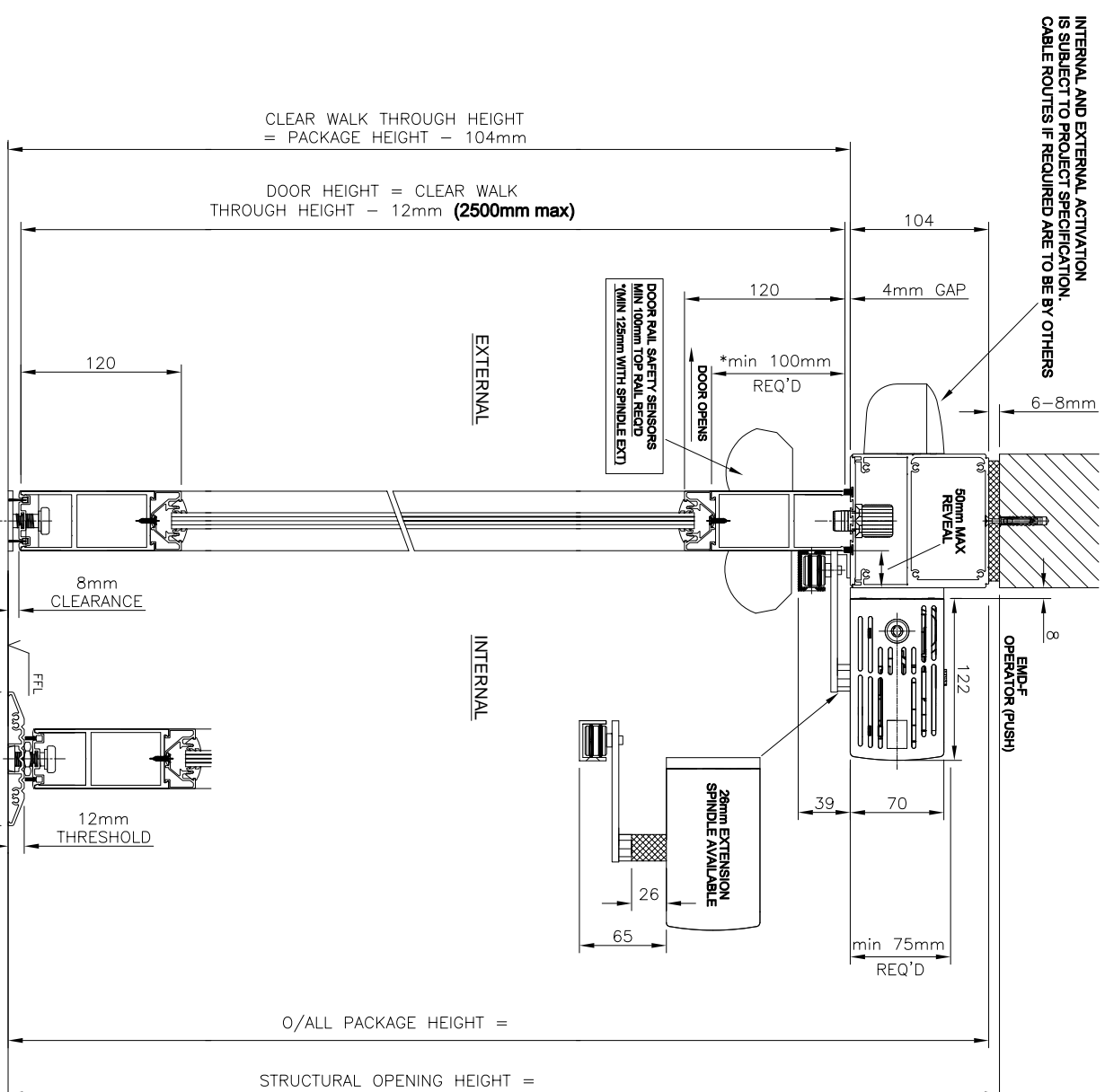

PROJECT SPECIFIC DETAILS

PROJECT :	
FINISH :	
GLASS :	
LOCKING :	
CONTROLS :	
ACTIVATION :	
SAFETY :	

Revision	Drawn	Date	Reason for Change
B	GH	2/6/10	MIN TOP RAIL INCREASED TO 100mm
A	GH	24/9/08	EMD moved down on elev

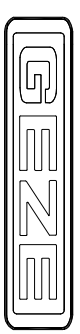

EMD-F TRANSDOM MOUNT PUSH (GUIDE CHANNEL) - Single RH with door & frame in Alum profiles (single glazed)

Drawn: GH, Appd: NTS, Scale: NTS, Date: JUL 08

www.geze.com
 Lichtfeld
 Staffordshire, TEL 01543 443000
 WS13 8SY, FAX 01543 443001

This drawing shows the actual stage of product development at the date indicated. It is not intended to be used for the construction of any building. It is the responsibility of the client to ensure that the drawing is up to date and that all necessary approvals have been obtained. An agreement with the client is required to amend or update this drawing. The drawing remains the property of GEZE and is not to be used without the express consent of GEZE.